

### Product Group VG/RE

Threaded plugs made of PA for rectangular tubes with injected plastic thread

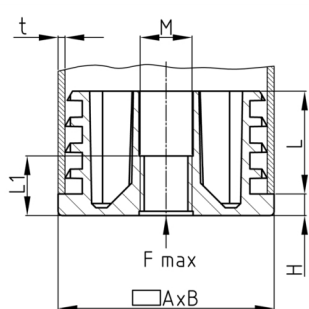

#### Standard Colours

- black RAL 9005

#### Material

- Polyamide (PA)

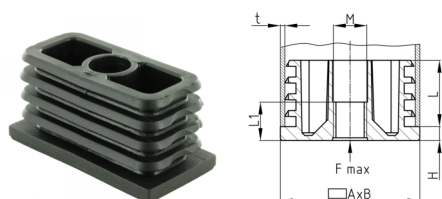

#### Product information

- The plugs are intended for use in pipes or equivalent bores with free passage corresponding to the clear nominal width of at least shaft length.
- For technical production reasons, a residual sprue may exceed the shaft length.
- Please note in the article category "Connecting elements" our pipe connection groups RVB 90 and RVB 180.

| Order Number         | A  | B  | F max. | H  | L  | L1   | M   | t     |
|----------------------|----|----|--------|----|----|------|-----|-------|
|                      | mm | mm | kg     | mm | mm | mm   |     | mm    |
| VG 40x20x1,5-2 / M8  | 40 | 20 | 200    | 5  | 24 | 14,5 | M8  | 1,5-2 |
| VG 40x25x1,5-2 / M8  | 40 | 25 | 200    | 5  | 24 | 14,5 | M8  | 1,5-2 |
| VG 40x30x1,5-2 / M8  | 40 | 30 | 200    | 5  | 24 | 14,5 | M8  | 1,5-2 |
| VG 50x20x1,5-2 / M8  | 50 | 20 | 200    | 5  | 24 | 14,5 | M8  | 1,5-2 |
| VG 50x25x1,5-2 / M8  | 50 | 25 | 200    | 5  | 24 | 14,5 | M8  | 1,5-2 |
| VG 50x30x1-1,5 / M8  | 50 | 30 | 200    | 5  | 24 | 14,5 | M8  | 1-1,5 |
| VG 50x30x1,5-2 / M8  | 50 | 30 | 200    | 5  | 24 | 14,5 | M8  | 1,5-2 |
| VG 60x25x1,5-2 / M8  | 60 | 25 | 200    | 5  | 24 | 14,5 | M8  | 1,5-2 |
| VG 60x30x1,5-2 / M8  | 60 | 30 | 200    | 5  | 24 | 14,5 | M8  | 1,5-2 |
| VG 60x40x1,5-2 / M8  | 60 | 40 | 200    | 5  | 24 | 14,5 | M8  | 1,5-2 |
| VG 40x20x1,5-2 / M10 | 40 | 20 | 200    | 5  | 24 | 14,5 | M10 | 1,5-2 |
| VG 40x25x1,5-2 / M10 | 40 | 25 | 200    | 5  | 24 | 14,5 | M10 | 1,5-2 |
| VG 40x30x1,5-2 / M10 | 40 | 30 | 200    | 5  | 24 | 14,5 | M10 | 1,5-2 |
| VG 50x20x1,5-2 / M10 | 50 | 20 | 200    | 5  | 24 | 14,5 | M10 | 1,5-2 |
| VG 50x25x1,5-2 / M10 | 50 | 25 | 200    | 5  | 24 | 14,5 | M10 | 1,5-2 |
| VG 50x30x1-1,5 / M10 | 50 | 30 | 200    | 5  | 24 | 14,5 | M10 | 1-1,5 |
| VG 50x30x1,5-2 / M10 | 50 | 30 | 200    | 5  | 24 | 14,5 | M10 | 1,5-2 |
| VG 60x25x1,5-2 / M10 | 60 | 25 | 200    | 5  | 24 | 14,5 | M10 | 1,5-2 |
| VG 60x30x1,5-2 / M10 | 60 | 30 | 200    | 5  | 24 | 14,5 | M10 | 1,5-2 |
| VG 60x40x1,5-2 / M10 | 60 | 40 | 200    | 5  | 24 | 14,5 | M10 | 1,5-2 |
| VG 40x30x1,5-2 / M12 | 40 | 30 | 200    | 5  | 24 | 14,5 | M12 | 1,5-2 |
| VG 50x30x1-1,5 / M12 | 50 | 30 | 200    | 5  | 24 | 14,5 | M12 | 1-1,5 |



# Walter Bethke GmbH & Co. KG

Technische Kunststoff - und Hybridprodukte

| Order Number         | A  | B  | F max. | H  | L  | L1   | M   | t     |
|----------------------|----|----|--------|----|----|------|-----|-------|
|                      | mm | mm | kg     | mm | mm | mm   |     | mm    |
| VG 50x30x1,5-2 / M12 | 50 | 30 | 200    | 5  | 24 | 14,5 | M12 | 1,5-2 |
| VG 60x30x1,5-2 / M12 | 60 | 30 | 200    | 5  | 24 | 14,5 | M12 | 1,5-2 |
| VG 60x40x1,5-2 / M12 | 60 | 40 | 200    | 5  | 24 | 14,5 | M12 | 1,5-2 |