

Product Group HKRV

Crank handle made of PA 6 with square adapter

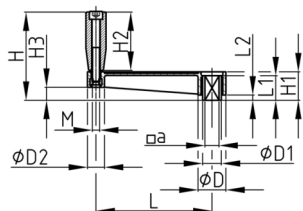

Standard Colours

- black

Material

- Base body: Polyamide (PA 6)
- Pivot: zinc plated steel
- Handle: thermosetting PF 31
- Thread bolt: zinc-plated steel
- Threaded bush: brass

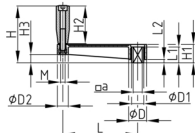

Order Number	a	D	D1	D2	H	H1	H2	H3	L	L1	L2	M
	mm	mm	mm	mm	mm	mm	mm	mm	mm	mm	mm	mm
HKRV 150 / 14	14	36	30	22	125	36	80	15	150	26	5	M10