

Product Group SHR4G

Spoked wheel made of thermosetting plastic with four spokes, sichtbarer Nabe and crank handle

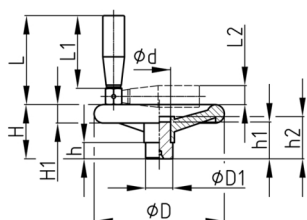

Standard Colours

- black

Material

- Base body: Thermosetting plastic
- Hub: zinc-plated steel

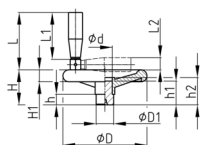

Product information

- Pilot bore for fit in hub available.
- Material and dimensions of the handle see product group UGZ.

| Order Number | D | d | D1 | H | h | H1 | h1 | h2 | L | L1 | L2 |
|----------------|-----|----|----|----|----|----|----|----|-----|----|----|
| | mm | mm | mm | mm | mm | mm | mm | mm | mm | mm | mm |
| SHR4G 100 / 24 | 100 | 21 | 24 | 47 | 17 | 15 | 36 | 39 | 60 | 46 | 17 |
| SHR4G 120 / 25 | 120 | 21 | 25 | 49 | 15 | 16 | 35 | 38 | 82 | 65 | 17 |
| SHR4G 140 / 28 | 140 | 23 | 28 | 54 | 17 | 20 | 38 | 41 | 82 | 65 | 17 |
| SHR4G 160 / 32 | 160 | 27 | 32 | 56 | 21 | 22 | 40 | 42 | 82 | 65 | 17 |
| SHR4G 200 / 40 | 200 | 32 | 40 | 72 | 25 | 25 | 47 | 51 | 107 | 86 | 21 |
| SHR4G 250 / 50 | 250 | 42 | 50 | 82 | 29 | 29 | 56 | 60 | 107 | 86 | 21 |
| SHR4G 300 / 52 | 300 | 42 | 52 | 95 | 30 | 35 | 63 | 68 | 107 | 86 | 21 |