

Product Group KVW/RE

Connector (right angle) made of PA 6 for rectangular tubes

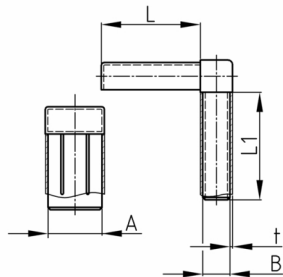

Standard Colours

- black

Material

- Polyamide 6 (PA 6)

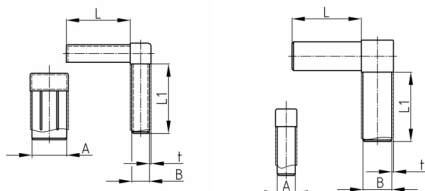

Product information

- For rectangular tubes to be connected together on edge.
- *) = For rectangular tubes to be connected flat together.
- For low to medium static load.
- One-piece variants cannot be retrofitted with a steel core.
- Two-part versions can be retrofitted with steel core.
- Two-piece variants are supplied unassembled.
- F = flat

Order Number	A	B	L	L1	t
	mm	mm	mm	mm	mm
KVW 30x15x1,5, einteilig	30	15	25	25	1,5
KVW 50x30x2, einteilig	50	30	32	32	2
KVW 50x30x2 F, zweiteilig *	30	50	40	40	2