

Product Group BE 68

Wing screws made of PA 6 with threaded bolt (overmoulded)

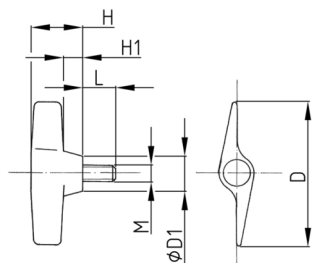

Standard Colours

- black

Material

- Base body: Polyamide (PA 6)
- Thread: zinc-plated steel

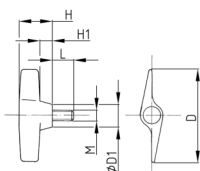

Order Number	D	D1	H	H1	L	M
	mm	mm	mm	mm	mm	mm
BE 68 M6x10	68	18	25	8	10	M6
BE 68 M6x12	68	18	25	8	12	M6
BE 68 M6x16	68	18	25	8	16	M6
BE 68 M6x18	68	18	25	8	18	M6
BE 68 M6x20	68	18	25	8	20	M6
BE 68 M6x25	68	18	25	8	25	M6
BE 68 M6x30	68	18	25	8	30	M6
BE 68 M6x35	68	18	25	8	35	M6
BE 68 M6x40	68	18	25	8	40	M6
BE 68 M6x45	68	18	25	8	45	M6
BE 68 M6x50	68	18	25	8	50	M6
BE 68 M8x16	68	18	25	8	16	M8
BE 68 M8x20	68	18	25	8	20	M8
BE 68 M8x25	68	18	25	8	25	M8
BE 68 M8x30	68	18	25	8	30	M8
BE 68 M8x35	68	18	25	8	35	M8
BE 68 M8x40	68	18	25	8	40	M8
BE 68 M8x45	68	18	25	8	45	M8
BE 68 M8x50	68	18	25	8	50	M8
BE 68 M8x60	68	18	25	8	60	M8