

### Product Group MFM

Machine feet made of stainless steel with rubber base

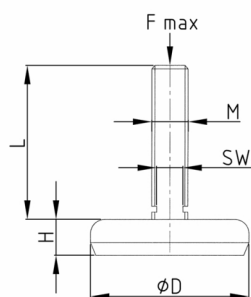

#### Standard Colours

- black

#### Material

- Thread: AISI 304 (A2)
- Rubber: NBR 72 Shore

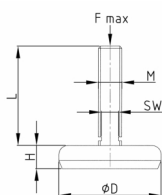

#### Product information

- The machine foot is characterized by a wide range of products, which allows great freedom in choosing the right model.
- The rounded and hygienic design of this type enables easy and quick cleaning.
- The embedded rubber meets the USDA standard for rubber products.
- The machine foot can compensate for uneven floors up to 5°.
- The load capacity of the screw (buckling length!) may be less than indicated in the table.

D	F max.	H	M	WAF	50	70	100	150	180	230	310
mm	kg	mm		mm	mm	mm	mm	mm	mm	mm	mm
40	200	20	M10	8	x	x	x	x	x	x	
40	200	20	M12	10	x	x	x	x	x	x	
40	200	20	M16	13		x	x	x	x	x	x
40	200	20	M20	15		x	x	x	x	x	x
40	200	20	M24	19		x	x	x	x	x	x
50	300	21	M10	8	x	x	x	x	x	x	
50	300	21	M12	10	x	x	x	x	x	x	
50	300	21	M16	13		x	x	x	x	x	x
50	300	21	M20	15		x	x	x	x	x	x
50	300	21	M24	19		x	x	x	x	x	x
75	800	22	M10	8	x	x	x	x	x	x	
75	800	22	M12	10	x	x	x	x	x	x	
75	800	22	M16	13		x	x	x	x	x	x
75	800	22	M20	15		x	x	x	x	x	x
75	800	22	M24	19		x	x	x	x	x	x
75	800	22	M30	24			x	x	x	x	x
100	2200	32	M12	10	x	x	x	x	x		
100	2000	32	M16	13		x	x	x	x	x	x
100	2000	32	M20	15		x	x	x	x	x	x
100	2000	32	M24	19		x	x	x	x	x	x
100	2000	32	M30	24		x	x	x	x	x	x



# Walter Bethke GmbH & Co. KG

Technische Kunststoff - und Hybridprodukte

D	F max.	H	M	WAF	50	70	100	150	180	230	310
mm	kg	mm		mm	mm	mm	mm	mm	mm	mm	mm
125	3000	37	M16	13	x	x	x	x	x	x	x
125	3000	37	M20	15	x	x	x	x	x	x	x
125	3000	37	M24	19	x	x	x	x	x	x	x
125	3000	37	M30	24	x	x	x	x	x	x	x
125	3000	37	M36	24				x	x	x	x
150	4000	40	M16	13	x	x	x	x	x	x	x
150	4000	40	M20	15	x	x	x	x	x	x	x
150	4000	40	M24	19	x	x	x	x	x	x	x
150	4000	40	M30	24	x	x	x	x	x	x	x
150	4000	40	M36	30			x	x	x	x	x
180	5000	40	M16	13	x	x	x	x	x	x	x
180	5000	40	M20	15	x	x	x	x	x	x	x
180	5000	40	M24	19	x	x	x	x	x	x	x
180	5000	40	M30	24	x	x	x	x	x	x	x
180	5000	40	M36	30			x	x	x	x	x
180	5000	40	M42	36			x	x	x	x	x

## Ordering example

• Group + D + M + Thread Length ---> MFM 100 M16 x 100