

Product Group MFHPG

Adjustable feet made of glass fibre reinforced polyamide with rubber base and stainless steel thread

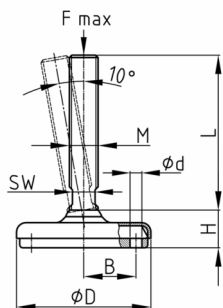

Standard Colours

- black

Material

- Thread: AISI 304 (A2)
- Base: glass fibre reinforced polyamide (PA-GF)
- Top cover: Polypropylene carbonate (PPC)
- Rubber: NBR 80 Shore

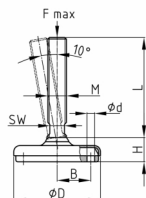

Product information

- The machine foot is particularly characterized by its hygienic construction, mounting flexibility and resistance to outer influences.
- From Ø 80 mm the foot can be screwed to the floor - for this purpose there are prepared screw holes (closed) below the clipped-on cover.
- The anti-slip rubber is vulcanized into the plastic disc.
- The machine foot can compensate for uneven floors up to 10°.
- The load capacity of the screw (buckling length!) may be less than indicated in the table.

D	H	B	d	F max.	M	WAF	70	100	150	180	230	310
mm	mm	mm	mm	kg		mm	mm	mm	mm	mm	mm	mm
60	33			1200	M12	10	x	x	x	x	x	
60	33			1200	M16	13	x	x	x	x	x	x
60	33			1200	M20	17	x	x	x	x	x	x
60	33			1200	M24	19	x	x	x	x	x	x
80	33	27	9	1200	M12	10	x	x	x	x	x	
80	33	27	9	1200	M16	13	x	x	x	x	x	x
80	33	27	9	1200	M20	17	x	x	x	x	x	x
80	33	27	9	1200	M24	19	x	x	x	x	x	x
100	39	32	11	2000	M12	10	x	x	x	x		
100	39	32	11	2000	M16	13	x	x	x	x	x	x
100	39	32	11	2000	M20	17	x	x	x	x	x	x
100	39	32	11	2000	M24	19	x	x	x	x	x	x
120	40	40	11	2000	M12	10		x	x	x	x	x
120	40	40	11	2000	M16	13	x	x	x	x	x	x
120	40	40	11	2000	M20	17	x	x	x	x	x	x
120	40	40	11	2000	M24	19	x	x	x	x	x	x

Ordering example

- Group + D + M + Thread Length ---> MFHPG 100 M16 x 100