

### Product Group KBKR

Round cable chain set made of PP for cable feed to writing or working tables

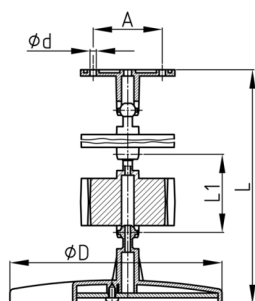

#### Standard Colours

- black
- white aluminium RAL 9006

#### Material

- Polypropylene (PP)

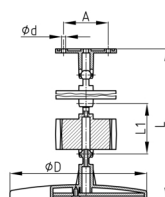

- Complete packing in one box (assembled chain segments with heavy metal sheet reinforced base and top segment with on-moulded cable clamps and with assembling screw set)

Order Number	A	d	D	L	L1	Element(s)	For up to x cable
	mm	mm	mm	mm	mm	piece(s)	piece(s)
KBKR 720 - 820 mm/ 15 / 8	64	4,5	141	720-820	50	15	8
KBKR 1170 - 1270 mm/ 24 / 8	64	4,5	141	1170-1270	50	24	8