

### Product Group MFSH

Machine feet made of zinced steel with two fixing holes and antislip-pad (A)

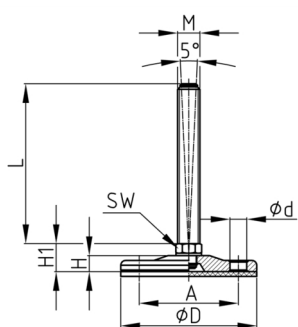

#### Material

- Base body: zinc-plated steel
- Antislip pad: NBR 70 Shore

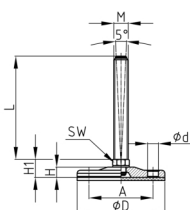

#### Product information

- The machine foot can compensate for uneven floors up to 5°.
- The thread is screwed into the foot and can be turned!
- The antislip pad is supplied without holes.
- The load capacity of the screw (buckling length!) may be less than indicated in the table.
- Palletising machines, conveyor systems, automation technology

#### Product options on inquiry

- Antislip pad made of NBR 80 shore
- Delivery with additional steel nut possible.

A	D	d	F max.	H	H1	M	WAF	50	75	100	125	150	175	200	225
mm	mm	mm	kg	mm	mm		mm	mm	mm	mm	mm	mm	mm	mm	mm
45	63	10,5	1800	11,5	19	M10	14	x		x					
45	63	10,5	1800	11,5	19	M12	14	x		x	x				
45	63	10,5	1800	11,5	19	M14	14	x		x	x				
45	63	10,5	1800	11,5	19	M16	16	x		x	x				
62	80	10,5	2000	11,5	20	M14	14	x		x		x			
62	80	10,5	2000	11,5	20	M10	14	x		x					
62	80	10,5	2000	11,5	20	M12	14	x		x					
62	80	10,5	2000	11,5	20	M16	16		x	x		x			
62	80	10,5	2500	11,5	20	M20	20		x		x		x		
76	100	10,5	3000	16	25	M16	20		x	x		x			
76	100	10,5	3000	16	25	M20	20		x		x		x		
76	100	10,5	3500	16	25	M24	24			x		x		x	
76	100	10,5	3500	16	26	M30	30				x		x		x
96	120	10,5	3500	16	25	M16	20		x	x		x			
96	120	10,5	4000	16	25	M20	20		x		x		x		
96	120	10,5	4500	16	25	M24	24			x		x		x	
96	120	10,5	4500	16	26	M30	30				x		x		x

#### Ordering example

- Group + D + M + Thread Length ---> MFSH 63 M10x 50 (A)