

Product Group MFSSD

Machine feet made of stainless steel with antislip pad

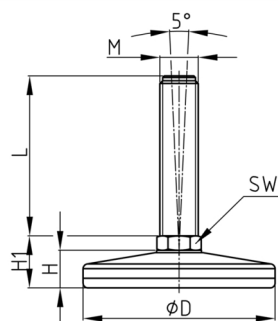

Material

- Base body: AISI 304 (A2)
- Antislip pad: NBR 90 Shore

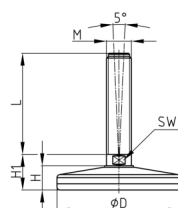
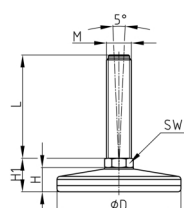

Product information

- Depending on the size of the thread or the foot diameter, the machine foot is provided with a chamfer on both sides or with a hexagon as a spanner flat.
- The thread is screwed into the foot and can be turned!
- The machine foot can compensate for uneven floors up to 5°.
- The load capacity of the screw (buckling length!) may be less than indicated in the table.
- Food industry, chemical industry, cosmetics industry, beverage industry, wine cellars

Product options on inquiry

- Machine foot made of stainless steel AISI 316 (A4)
- Delivery with additional steel nut possible.

D	F max.	H	H1	M	WAF	25	50	75	100	125	150	175	200	225	250
mm	kg	mm	mm		mm	mm	mm	mm	mm	mm	mm	mm	mm	mm	mm
60	1500	17,5	24,5	M10	14	x	x	x	x						
60	1500	17,5	24,5	M12	14	x	x	x	x	x					
60	1500	17,5	24,5	M14	14		x	x	x	x	x				
75	2000	20	28	M12	14		x	x	x	x					
75	2000	20	28	M14	14		x	x	x	x	x				
75	2000	20	32,5	M16	13		x	x	x	x	x	x			
75	2000	20	32,5	M20	17		x	x	x	x	x	x	x	x	
100	3000	25	37	M16	17		x	x	x	x	x	x	x		
100	3000	25	37	M20	17		x	x	x	x	x	x	x	x	x
100	3000	25	38	M24	20			x	x	x	x	x	x	x	x
120	4000	24	36,5	M16	17		x	x	x	x	x	x	x	x	
120	4000	24	36,5	M20	17			x	x	x	x	x	x	x	x
120	4000	24	37,5	M24	20			x	x	x	x	x	x	x	x
120	4000	24	37,5	M30	26			x	x	x	x	x	x	x	x
150	5000	26,5	39	M20	17			x	x	x	x	x	x	x	x
150	5000	26,5	40	M24	20				x	x	x	x	x	x	x
150	5000	26,5	40	M30	26				x	x	x	x	x	x	x



Walter Bethke GmbH & Co. KG

Technische Kunststoff - und Hybridprodukte

Ordering example

• Group + D + M + Thread Length ---> MFSSD 60 M10x 25 A