

Product Group VJG

Adjusting plugs made of PA 6 for square tubes with anti-slip plug, one-piece outer body and injection moulded thread

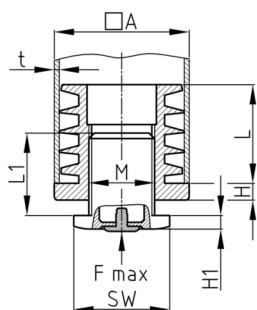

Standard Colours

- black RAL 9005

Material

- Polyamide 6 (PA 6)
- Anti-slip insert: Polyurethane (PUR)

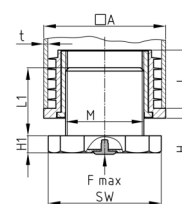
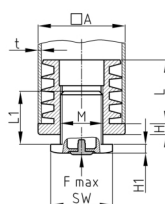

- The feet must be adjusted in an unloaded state.
- The specified axial, static load capacity refers to a screw turned out 10 mm and resting on the full surface.
- Adjusting plugs are not suitable as load gliders.
- Adjusting plugs are not suitable for dynamic load.

• *) = The lamella shape of the nut can be closed or interrupted

• ***) = from Ø 60 mm supplied with mounted threaded shell

• Please observe the material hints for polyamide (PA).

Product options on inquiry

- Further sizes
- Other special productions

Order Number	A	F max.	H	H1	L	L1	M	WAF	t
	mm	kg	mm	mm	mm	mm		mm	mm
VJG 25x25x1-1,5 /M16x25 /8k	25	150	5	5	20	22,5	M16	24	1-1,5
VJG 25x25x1,5-2 /M16x25 /8k	25	150	5	5	20	22,5	M16	24	1,5-2
VJG 30x30x1-1,5 /M22x25 /8k	30	300	5	5	19,5	29	M22	28	1-1,5
VJG 30x30x1,5-2 /M22x25 /8k *	30	300	5	5	19,5	29	M22	28	1,5-2
VJG 35x35x1,5-2 /M22x25 /8k	35	300	5	5	29,3	29	M22	28	1,5-2
VJG 35x35x2-2,5 /M22x25 /8k	35	300	5	5	29,3	29	M22	28	2-2,5
VJG 40x40x1,5-2 /M22x25 /8k	40	300	5	5	29,3	29	M22	28	1,5-2
VJG 40x40x2-2,5 /M22x25 /8k	40	300	5	5	29,3	29	M22	28	2-2,5
VJG 45x45x1,5-2 /M30x30 /8k	45	300	5	5	29,3	31	M30	41	1,5-2
VJG 50x50x1,5-2 /M30x30 /8k	50	300	5	5	29,3	31	M30	41	1,5-2
VJG 50x50x2-2,5 /M30x30/8k	50	300	5	5	29,3	31	M30	41	2-2,5
VJG 60x60x1,5-2/S42x2x40/12k ***	60	175	6	10	34,8	37	M42x2	58	1,5-2